

**RAISED TRUNCATED DOME PATTERN
(IN-LINE)**

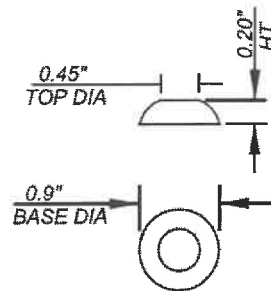

RAISED TRUNCATED DOME

DETECTABLE WARNING TILE
MANUFACTURED BY ADA SOLUTIONS
PRODUCT COMPANY OR APPROVED EQUAL

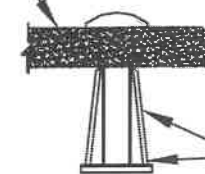

ANCHOR DETAIL

STEEL CONCRETE ANCHOR
MANUFACTURED BY ADA SOLUTIONS
PRODUCT COMPANY OR APPROVED EQUAL

NOTES:

- 1.) DETECTABLE WARNING, MOUNTED FLUSH, SURFACE SHALL BE CAST-IN-PLACE DETECTABLE WARNING TILE WITH STEEL ANCHORS, MANUFACTURED BY ADA SOLUTIONS OR APPROVED EQUAL, AND SHALL MEET ALL ADA REQUIREMENTS AS WELL AS STATE TITLE 24 REQUIREMENTS.
- 2.) COLOR SHALL BE YELLOW CONFORMING TO FEDERAL STANDARD 595B, COLOR No 33538.
- 3.) DETECTABLE WARNING SURFACE SHALL CONFORM TO THE DETAILS ON THIS STANDARD PLAN.
- 4.) DETECTABLE WARNING SURFACE SHALL BE FULL WIDTH OF RAMP AND 3 FOOT MINIMUM IN DEPTH OF RAMP AND UTILIZE A SINGLE PIECE.
- 5.) DETECTABLE WARNING SURFACE SHALL BE INSTALLED SO THAT DOMES ARE ALIGNED PARALLEL TO CENTERLINE OF ACCESS RAMP.
- 6.) THE EDGE OF THE DETECTABLE WARNING SURFACE NEAREST THE STREET SHALL BE BETWEEN 6" AND 8" FROM THE GUTTER FLOW LINE.
- 7.) RETROFIT INSTALLATION SHALL BE DETECTABLE WARNING TILE (PER NOTE 1) TIED DOWN TO EXISTING RAMP SURFACE WITH ANCHORS AND SEALED WITH WATERPROOFING ADHESIVE. NO SELF-ADHESIVE SURFACE APPLIED DOME MATS ALLOWED. TILE SHALL BE INSTALLED FLUSH WITH THE RAMP SURFACE. PERIMETER "LIP" SHALL NOT EXCEED 1/4".

NOT TO SCALE



RECOMMENDED:

Henry 7/16/19
DIVISION MANAGER DATE

APPROVED:

McWep 10/16/19
PUBLIC WORKS DIRECTOR / DATE
CITY ENGINEER

CITY OF MORENO VALLEY
PUBLIC WORKS DEPARTMENT - CAPITAL PROJECTS DIVISION

**DETECTABLE WARNING SURFACE
DETAILS AND NOTES**

STANDARD PLAN
MVSI-114C-2

SHEET 3 OF 4