

PEN25-0020 – MoVal 2040 Project: 2040 General Plan Update, Municipal Code and Zoning (including Zoning Atlas) Amendments, and Climate Action Plan

City of Moreno Valley Zoning Atlas			
<u>Revised Sheet Numbers</u>			
47	71	97	128
50	72	98	140
51	75	99	141
52	81	100	155
56	82	111	
57	83	112	
58	84	113	
59	85	114	
68	86	125	
70	87	126	

The information shown on this map was compiled from the Riverside County GIS and the City of Moreno Valley GIS. The best care and utility of information on this map is for display purposes only and should not be relied on or used as a basis for any legal action. The City of Moreno Valley and the Riverside County GIS do not assume any liability for any errors, omissions or damages resulting from the use of this map.

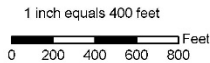
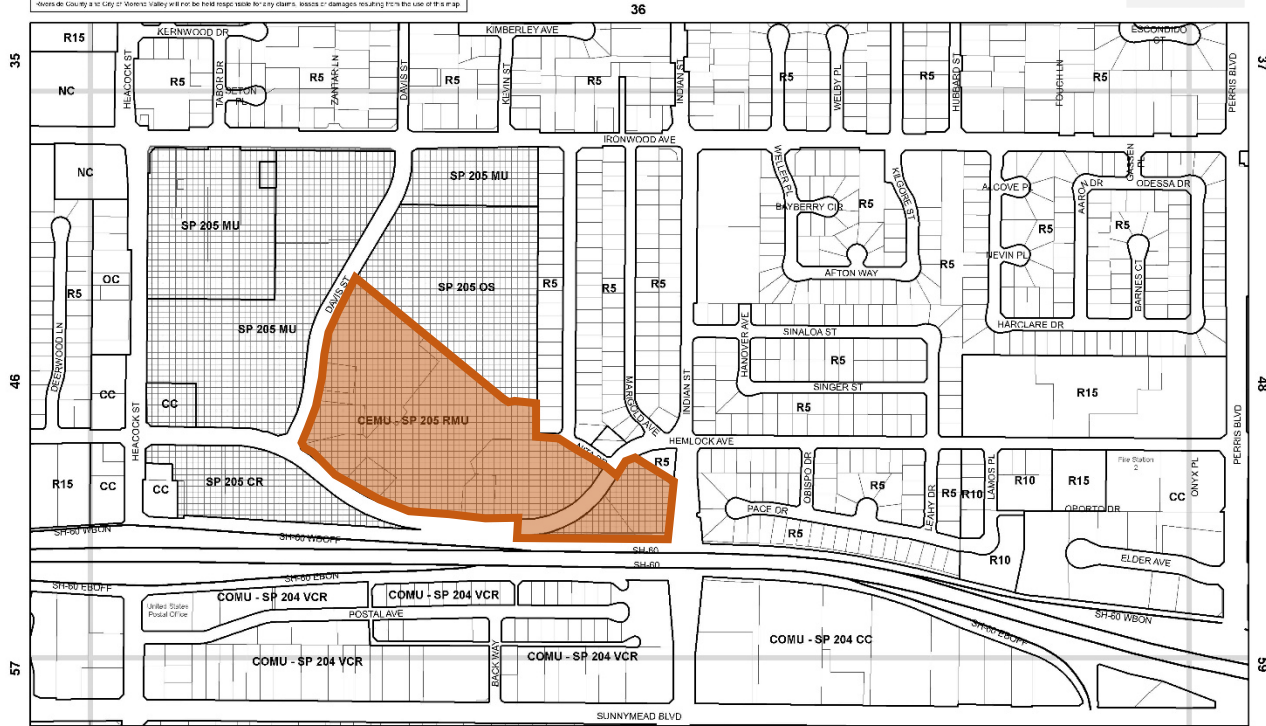

City of Moreno Valley Zoning Atlas



47

Current Zoning: SP 205 RMU
Proposed Zoning: CEMU SP 205 RMU



The information shown on this map was compiled from the Kinross County GIS and the City of Moreno Valley GIS. The base and utility information on this map is for display purposes only and should not be used as a final record or contractor site to its accuracy. Kinross County and City of Moreno Valley will not be held liable for any errors, omissions or damages resulting from the use of this map.

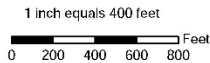
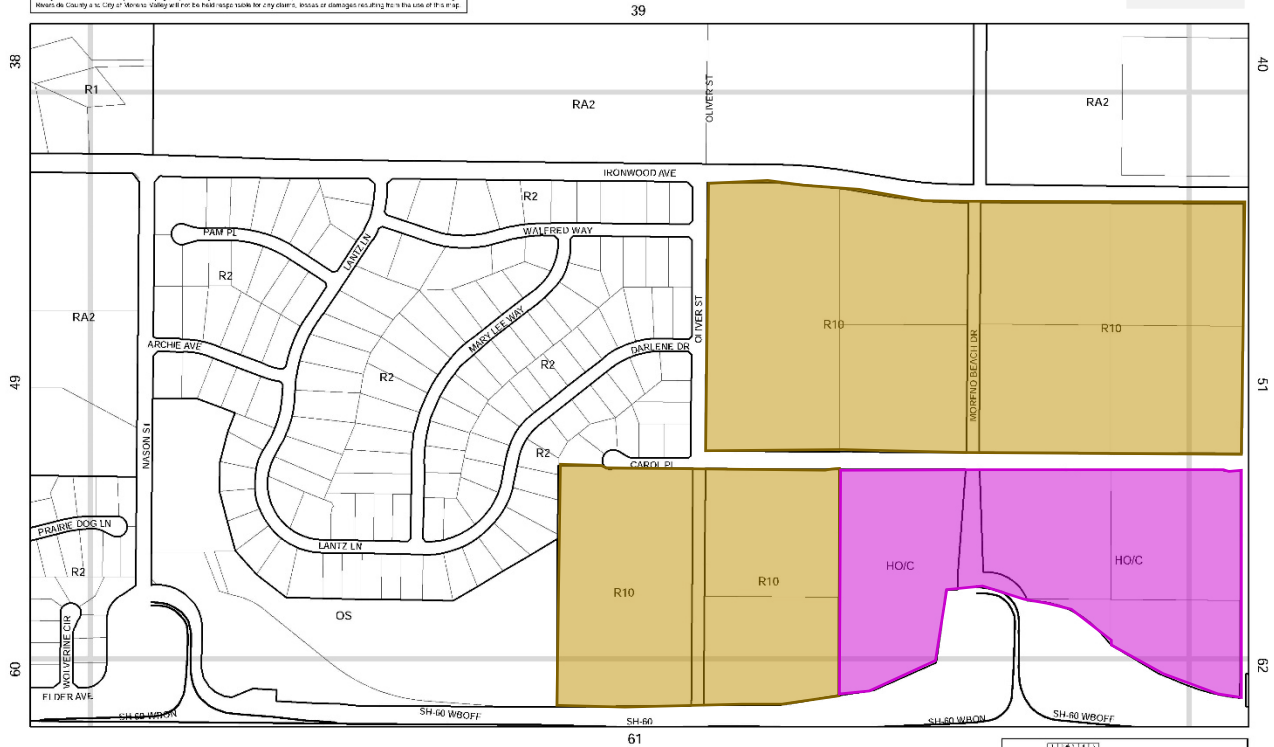

City of Moreno Valley Zoning Atlas

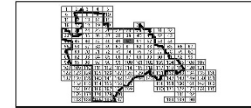

50

Current Zoning: R2 & RA2
Proposed Zoning: R10

Current Zoning: OC
Proposed Zoning: HO/C

The information shown on this map was compiled by the Riverside County GIS and the City of Moreno Valley GIS. The information is for informational purposes only and should not be relied upon without independent verification. Riverside County and City of Moreno Valley will not be responsible for any claims, losses or damages resulting from the use of this map.

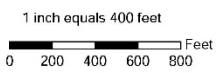
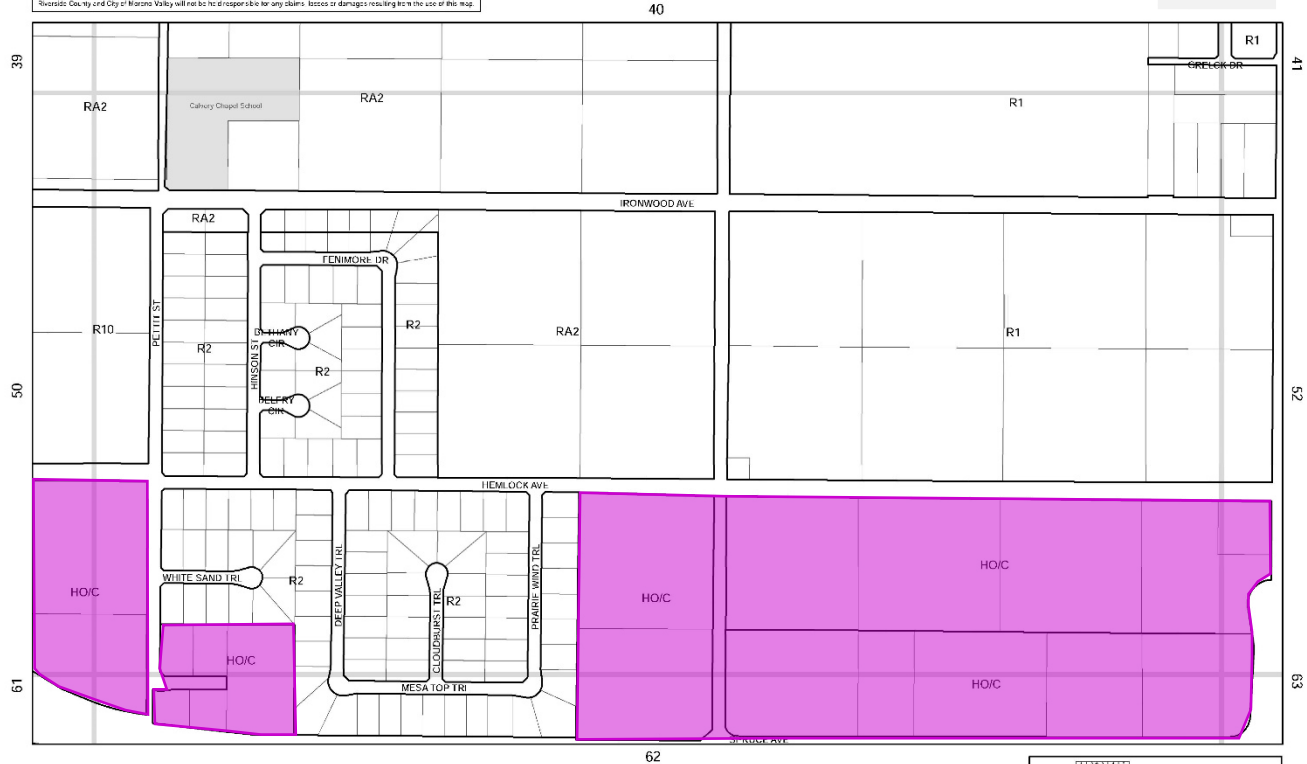

City of Moreno Valley Zoning Atlas

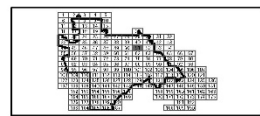

Current Zoning: R1, R2, RA2 & O
 Proposed Zoning: HO/C

An electronic version of this map was originally filed in the Kern County GIS and the City of Moreno Valley GIS. The board has a right to be notified on or after the time to be set for public hearing and shall not be held liable for any errors, omissions or damages resulting from the use of this map. Successive County and City of Moreno Valley will not be held responsible for any errors, omissions or damages resulting from the use of this map.

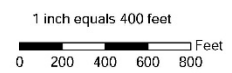
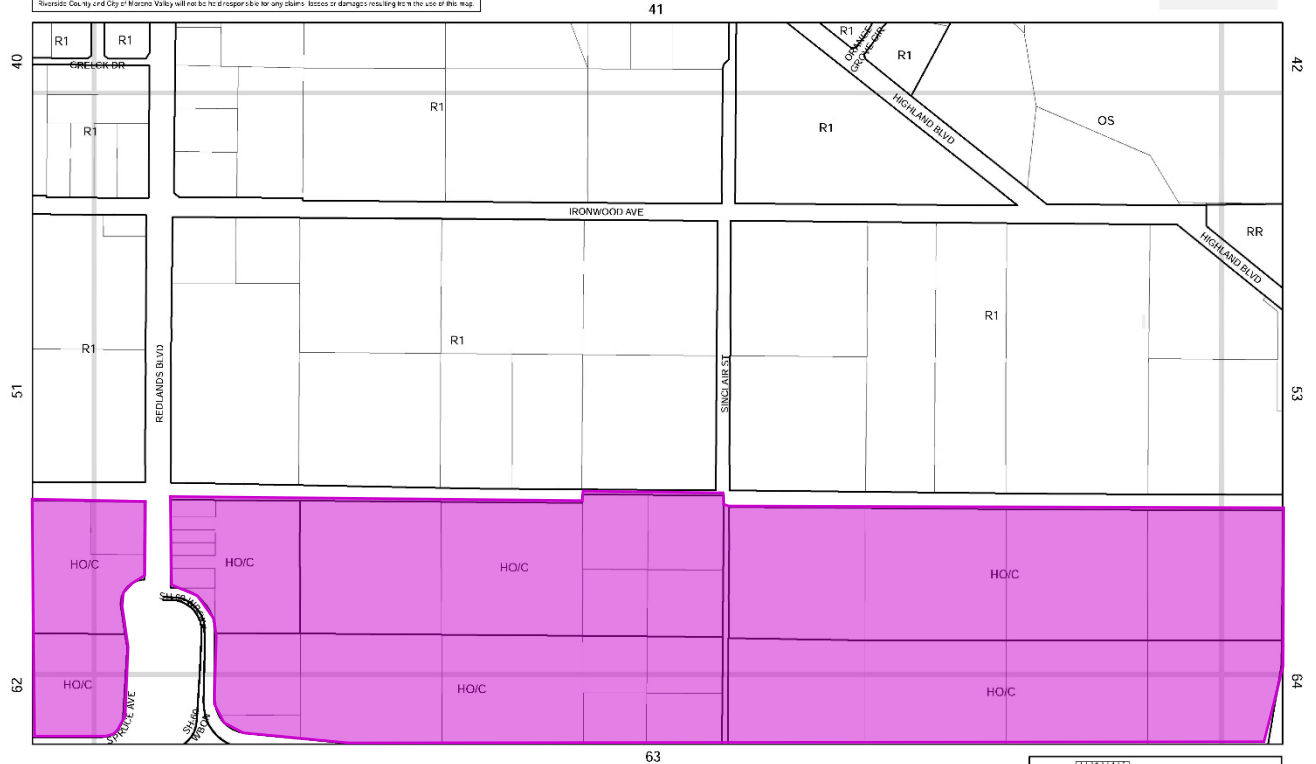

City of Moreno Valley Zoning Atlas

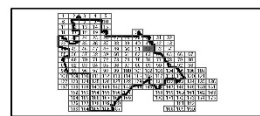

Current Zoning: R1 & O
 Proposed Zoning: HO/C

All information shown on this map was compiled by the Inland Empire GIS for the City of Moreno Valley GIS. The City of Moreno Valley is not responsible for any errors or omissions on this map. The City of Moreno Valley and City of Moreno Valley will not be held responsible for any claims, losses or damages resulting from the use of this map.

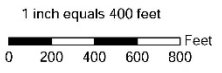
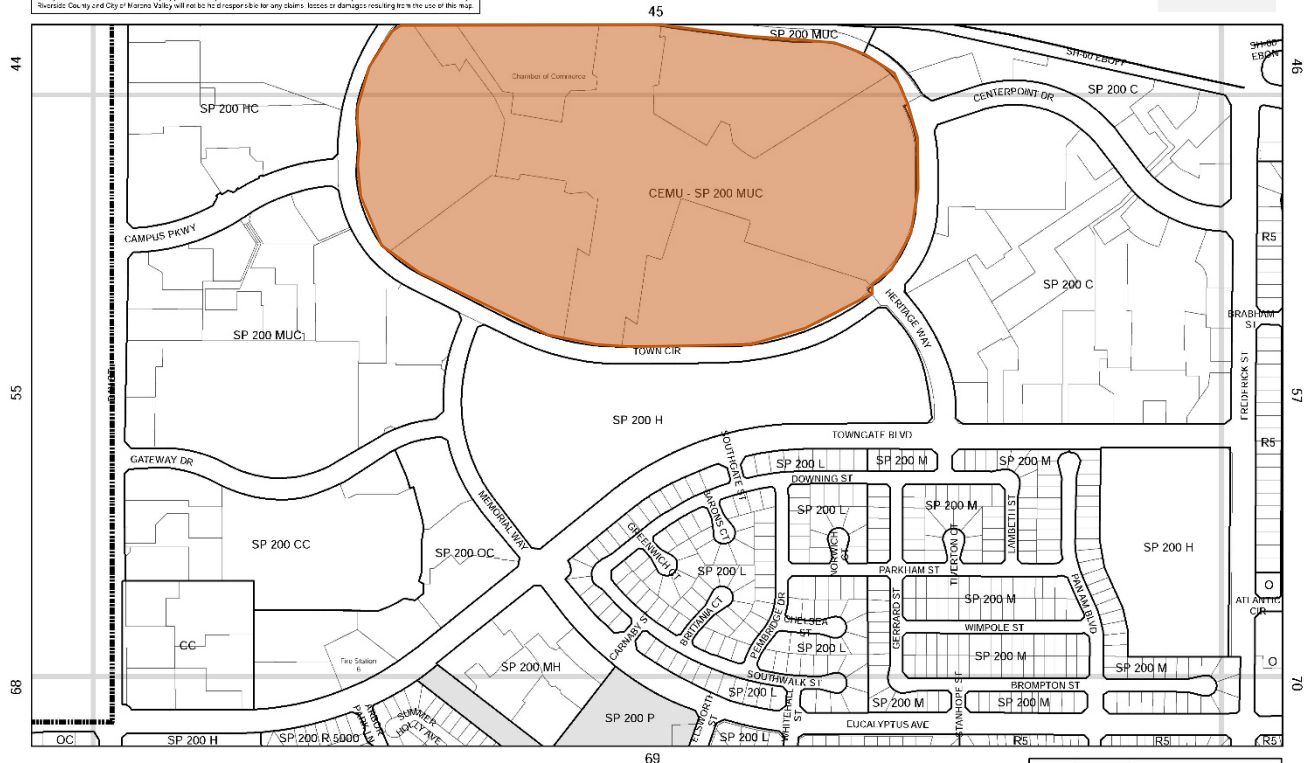

City of Moreno Valley Zoning Atlas

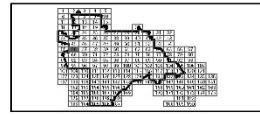

Current Zoning: SP 200 MUC
Proposed Zoning: CEMU SP 200 MUC

The information shown on this map was compiled from the Incentive Company GIS and the City of Moreno Valley GIS. The board makes a best effort to ensure the information on this map is for informational purposes only and does not constitute a warranty. The City of Moreno Valley and the City of Moreno Valley will not be held responsible for any claims, losses or damages resulting from the use of this map.

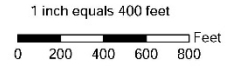
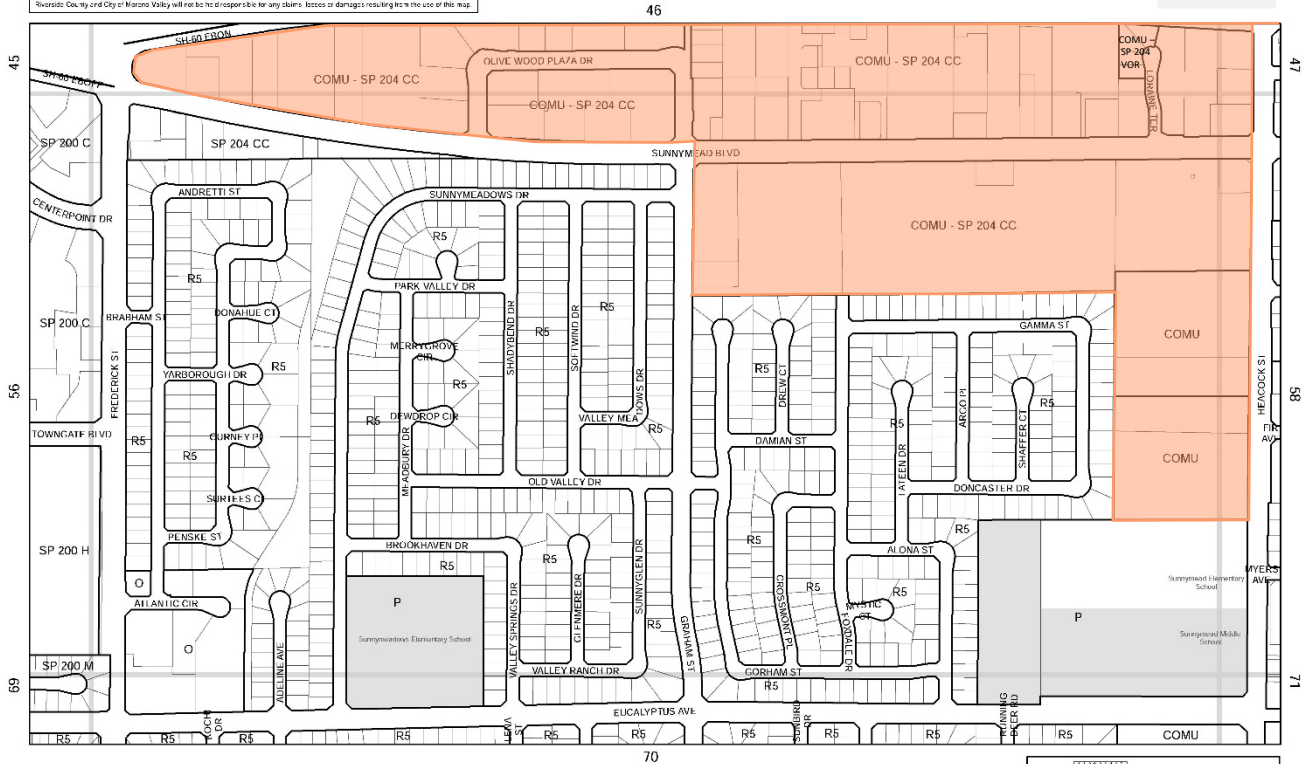

City of Moreno Valley Zoning Atlas



Current Zoning: SP 204 CC & VOR	
Proposed Zoning: COMU- SP 204 CC & VOR	
Current Zoning: CC & O	
Proposed Zoning: COMU	

All information shown on this map was compiled by the Riverside County GIS and the City of Moreno Valley GIS. The board does not warrant information on this map for design purposes only and does not warrant to any other. Please contact Riverside County or City of Moreno Valley for more information or any other issues or damages resulting from the use of this map.

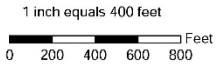
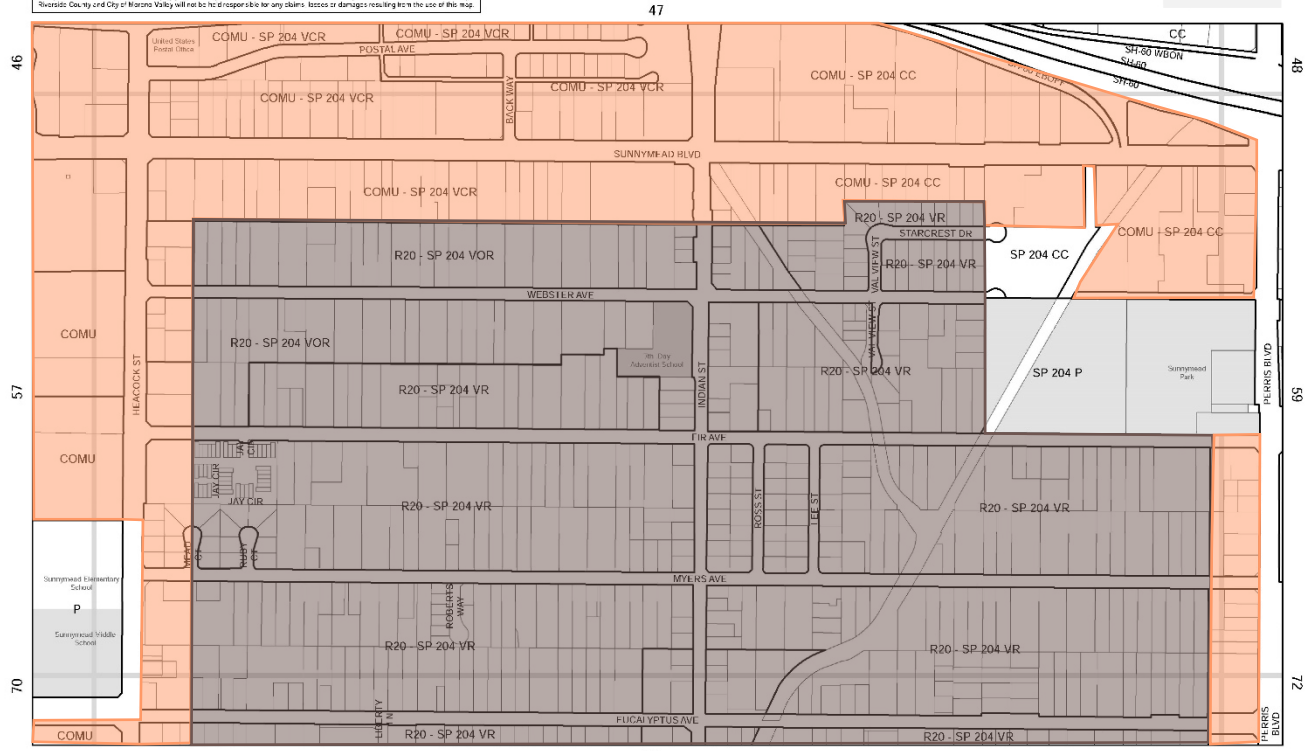

City of Moreno Valley Zoning Atlas



Current Zoning: SP 204 CC, VCR & VOR
 Proposed Zoning: COMU- SP 204 CC, VCR & VOR

Current Zoning: CC & O
 Proposed Zoning: COMU

Current Zoning: SP 204 VR
 Proposed Zoning: R20 - SP 204 VR

The information shown on this map was compiled from the Riverside County GIS and the City of Moreno Valley GIS. The lot, area and zoning information on this map is for display purposes only and should not be used for a final decision. No warranty is made by the City of Moreno Valley as to the accuracy of the information shown on this map. Errors or omissions notwithstanding, the City of Moreno Valley will not be held liable for any claims, losses or damages resulting from the use of this map.

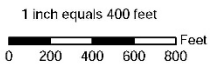
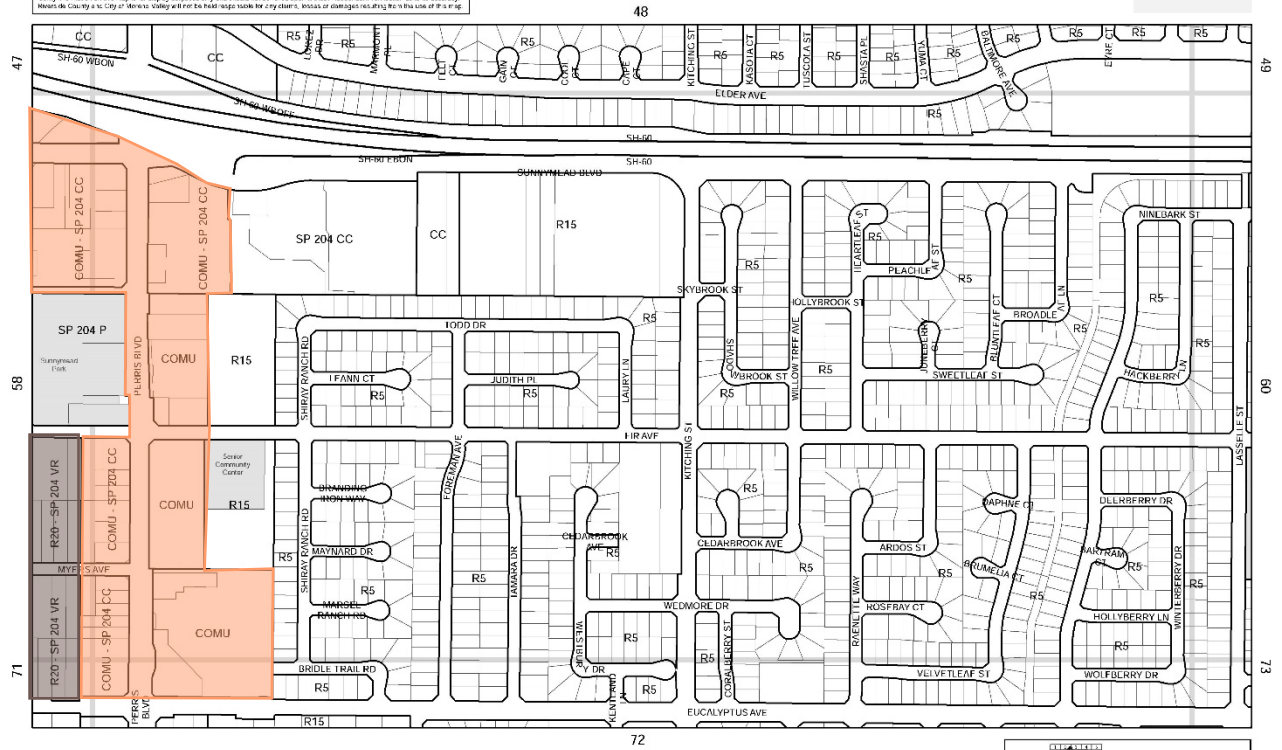

City of Moreno Valley Zoning Atlas

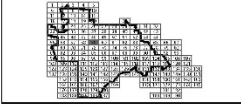

59

Current Zoning: SP 204 CC
 Proposed Zoning: COMU- SP 204 CC

Current Zoning: SP 204 VR
 Proposed Zoning: R20 - SP 204 VR

Current Zoning: NC, R10 & O
 Proposed Zoning: COMU

The information shown on this map was compiled by the Riverside County GIS and the City of Moreno Valley GIS. The information is for informational purposes only and does not constitute an offer. The City of Moreno Valley and the City of Riverside County will not be held responsible for any claims, losses or damages resulting from the use of this map.

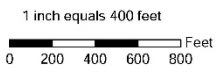
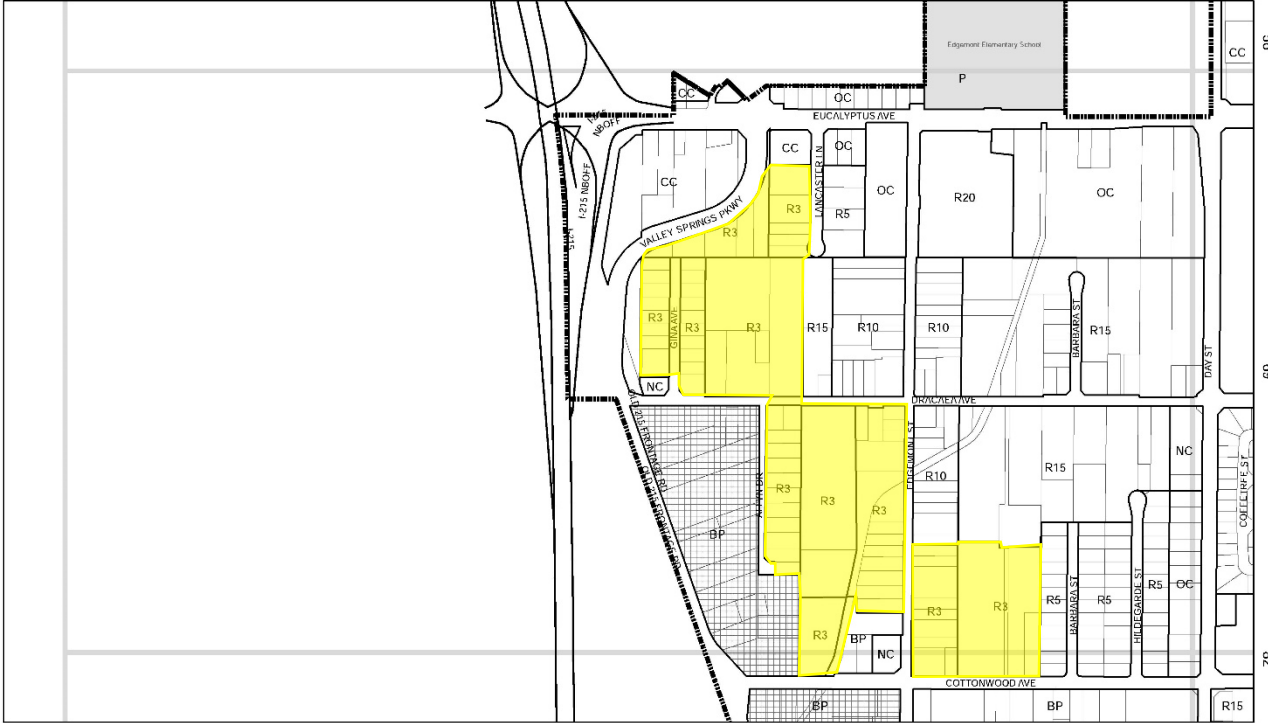

City of Moreno Valley Zoning Atlas

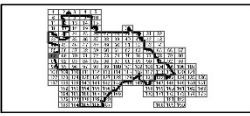

Current Zoning: OC, R5, R10 & R15
Proposed Zoning: R3

The information shown on this map was compiled by the Moreno Valley GIS Unit for the City of Moreno Valley GIS. The board has a 30-day information on this map is for planning purposes only and does not constitute an offer. Higher density zoning is to be approved. Riverside County and City of Moreno Valley will not be held responsible for any claims, losses or damages resulting from the use of this map.

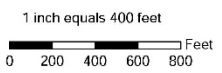
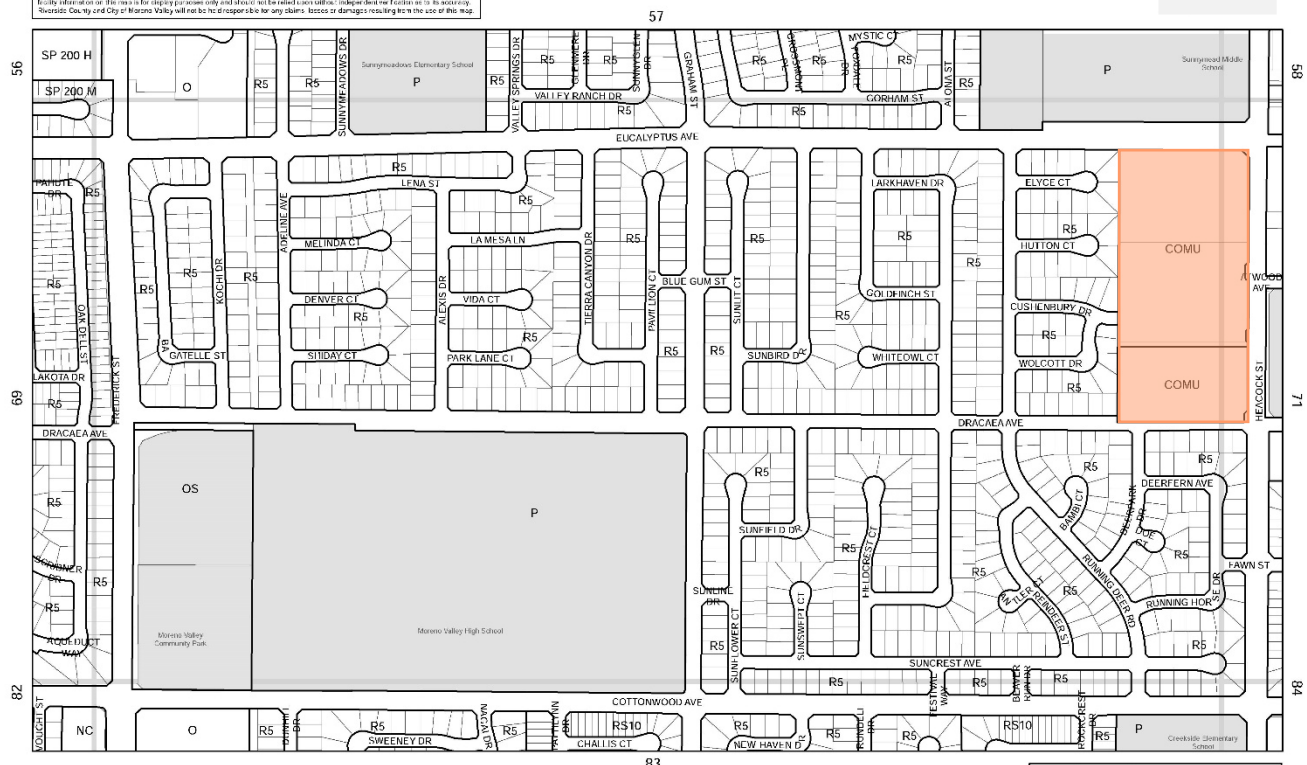

City of Moreno Valley Zoning Atlas

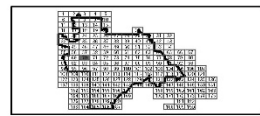

Current Zoning: R20
Proposed Zoning: COMU



This information was prepared for the use of the City of Moreno Valley. The City of Moreno Valley is not responsible for any claims, losses or damages resulting from the use of this map.

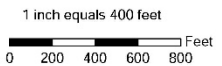

City of Moreno Valley Zoning Atlas

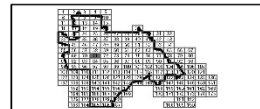

Current Zoning: SP 204 CC & VOR
Proposed Zoning: COMU- SP 204 CC & VOR

Current Zoning: SP 204 VR & VCR
Proposed Zoning: R20 - SP 204 VR & VCR

Current Zoning: R20 & CC
Proposed Zoning: COMU

The information shown on this map was compiled by the Riverside County GIS via the City of Moreno Valley GIS. The best source of City information on this map is for display purposes only and should not be relied upon without independent verification as to its accuracy. Riverside County and City of Moreno Valley will not be responsible for any claims, losses or damages resulting from the use of this map.

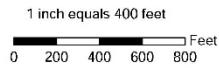

City of Moreno Valley Zoning Atlas



Current Zoning: O, OC, R10 & CC
Proposed Zoning: COMU

Current Zoning: SP 204 CC
Proposed Zoning: COMU – SP 204 CC

All information shown on this map was compiled from the Riverside County GIS data for the City of Moreno Valley (CM). This map does not constitute an official map of the City of Moreno Valley. The City of Moreno Valley is not responsible for any claims, losses or damages resulting from the use of this map.

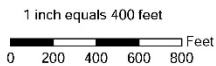
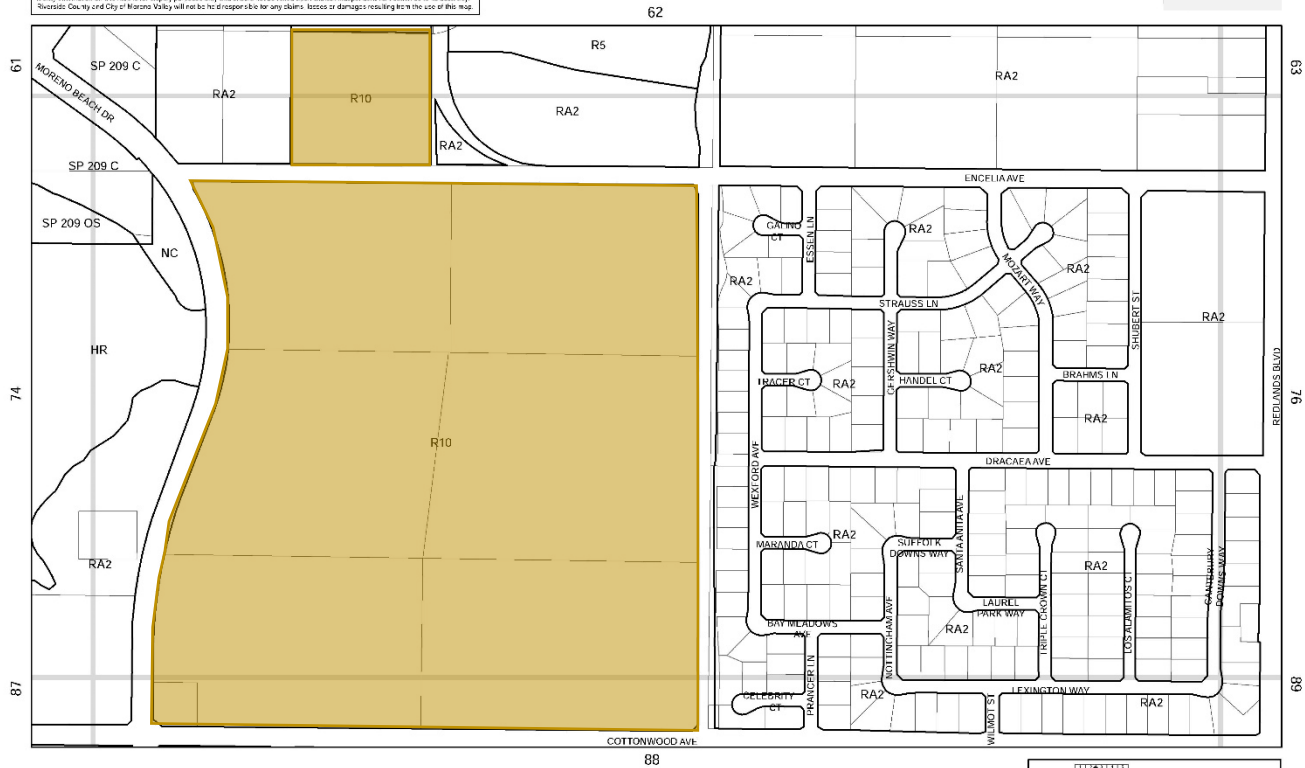

City of Moreno Valley Zoning Atlas



Current Zoning: HR & RA2
Proposed Zoning: R10



The information shown on this map was compiled from the Riverside County GIS and the City of Moreno Valley GIS. The user bears all liability for use of this map for any purpose other than that intended by the City of Moreno Valley. The City of Moreno Valley will not be responsible for any claims, losses or damages resulting from the use of this map.

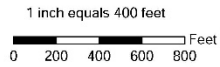

City of Moreno Valley Zoning Atlas

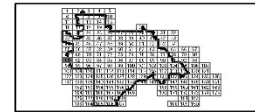

81

Current Zoning: CC
Proposed Zoning: BF



Current Zoning: R10
Proposed Zoning: R3

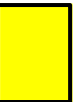

This information is provided for informational purposes only and does not constitute an offer of insurance. The City of Moreno Valley does not provide insurance. The City of Moreno Valley will not be held responsible for any claims, losses or damages resulting from the use of this map.

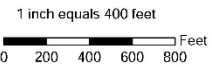
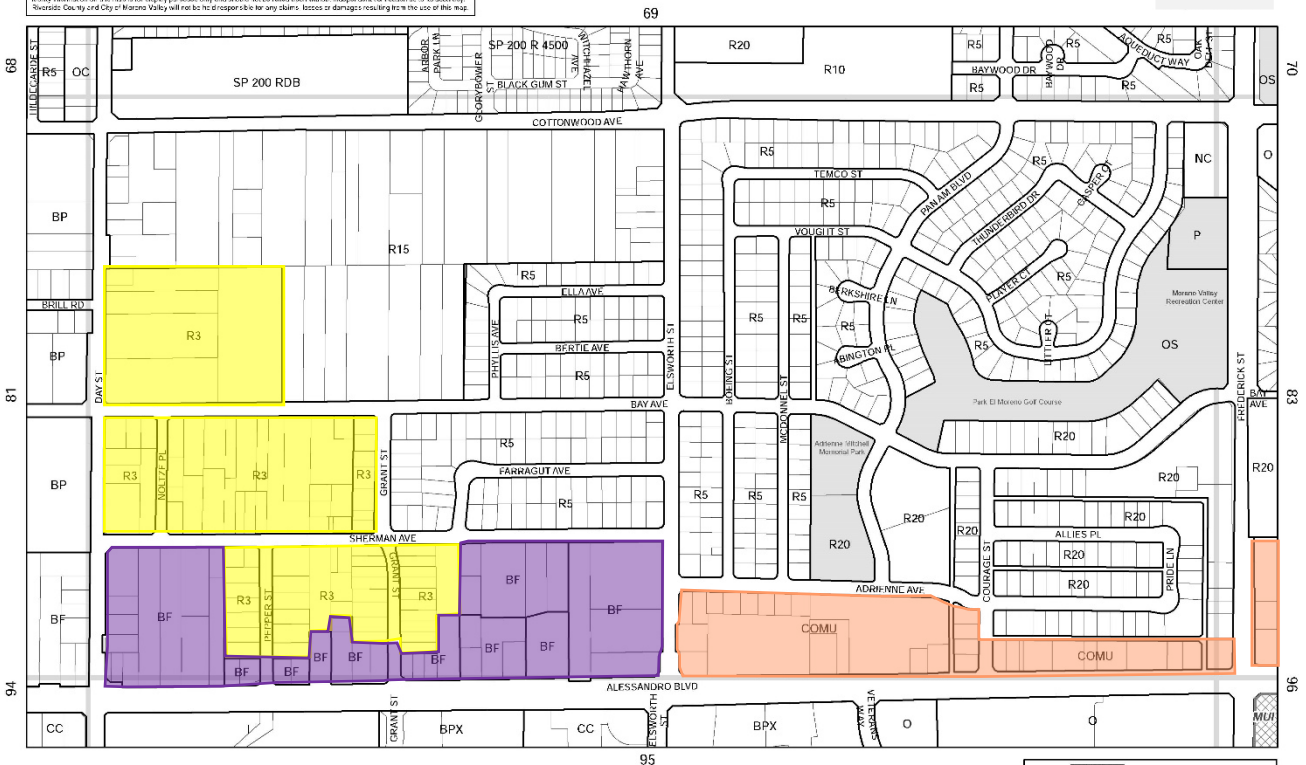

City of Moreno Valley Zoning Atlas

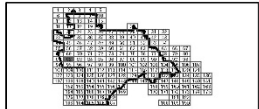

Current Zoning: CC, R30 & R10
Proposed Zoning: BF

Current Zoning: CC, R30 & NC
Proposed Zoning: COMU

Current Zoning: R10
Proposed Zoning: R3

The information shown on this map was compiled from the Alameda County GIS and the City of Moreno Valley GIS. The best known source of information on this map is for display purposes only and should not be relied upon without independent verification as to its accuracy. Riverside County and City of Moreno Valley will not be held responsible for any claims, losses or damages resulting from the use of this map.

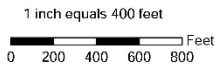
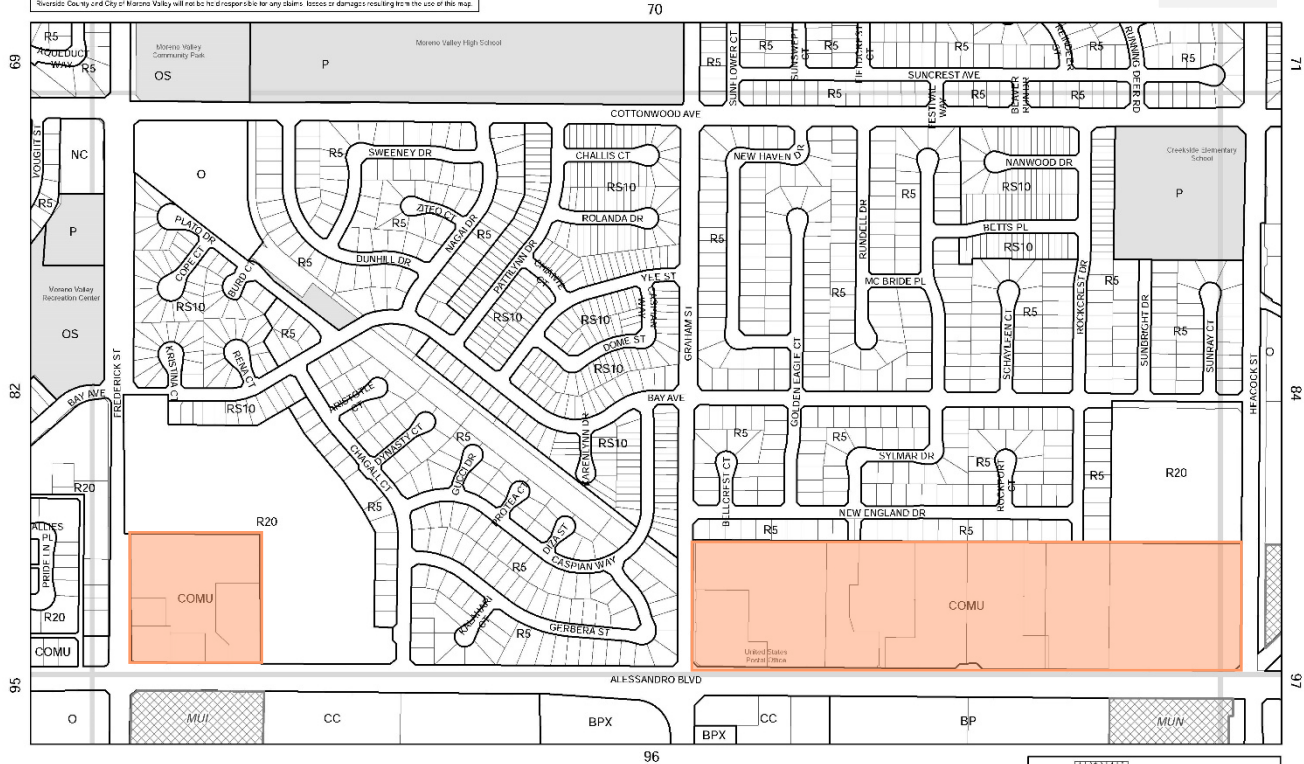

City of Moreno Valley Zoning Atlas



Current Zoning: NC
Proposed Zoning: COMU

All information shown on this map was compiled from the records of the City of Moreno Valley. The information is for informational purposes only and does not constitute an offer. Independent verification is recommended. The City of Moreno Valley and City of Moreno Valley will not be held responsible for any claims, losses or damages resulting from the use of this map.

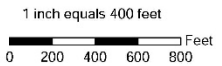
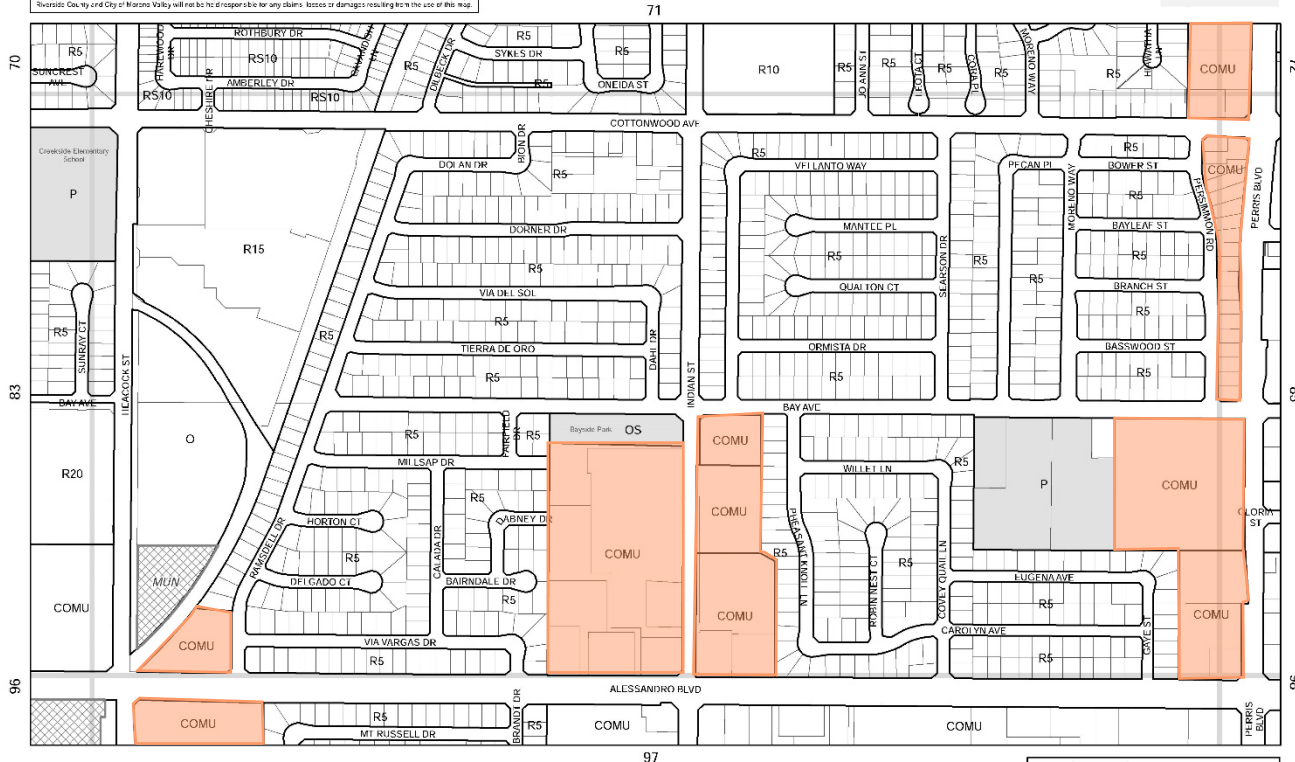

City of Moreno Valley Zoning Atlas

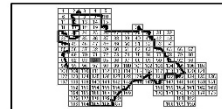

Current Zoning: NC, CC, R15 & R5
Proposed Zoning: COMU

The information shown on this map was compiled from the Riverside County GIS data, the City of Moreno Valley GIS. The intent here is to provide information on the map for design purposes only and does not constitute a contract. The City of Moreno Valley, Riverside County, and City of Moreno Valley will not be held responsible for any claims, losses or damages resulting from the use of this map.

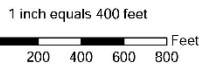
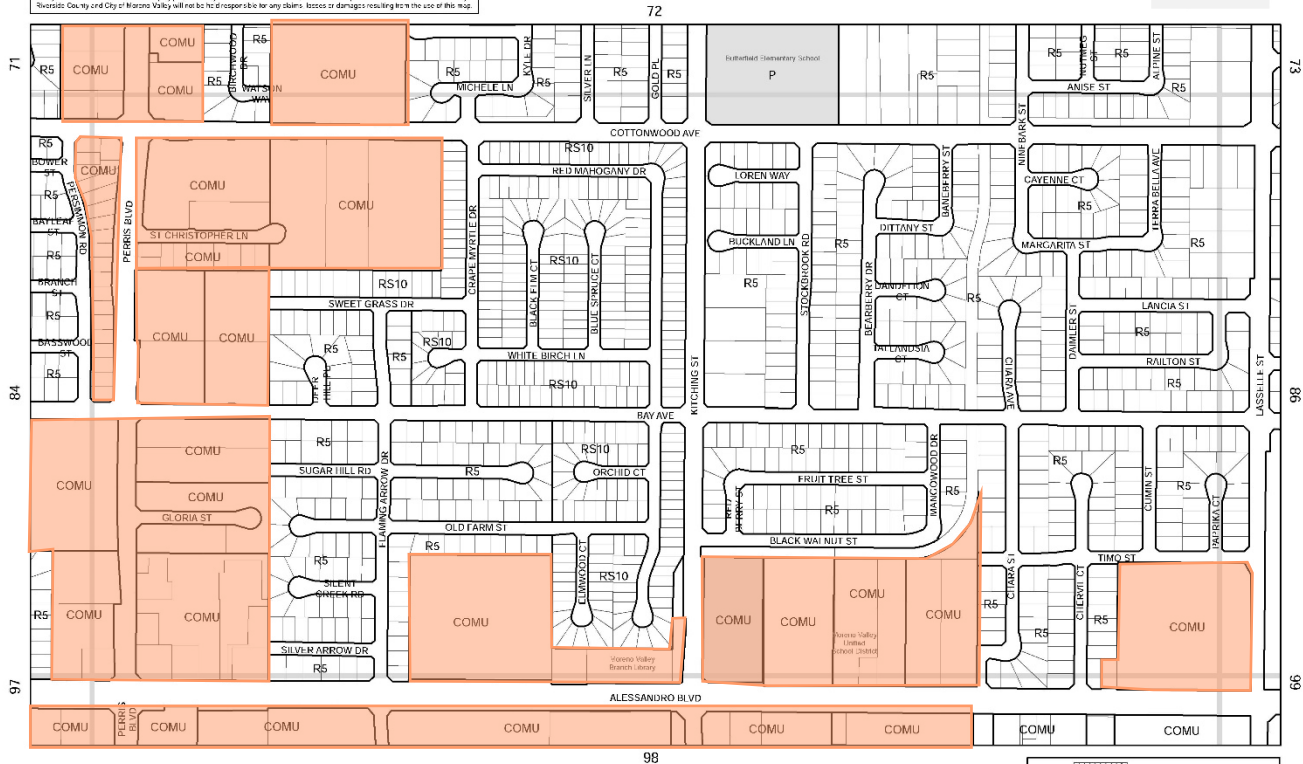

City of Moreno Valley Zoning Atlas



Current Zoning: R5, R10, R15, OC, O, CC & NC
Proposed Zoning: COMU

This information shown on this map was compiled by the Riverside County GIS and the City of Moreno Valley GIS. The information is for informational purposes only and does not constitute an offer of insurance. Riverside County and City of Moreno Valley will not be responsible for any claims, losses or damages resulting from the use of this map.

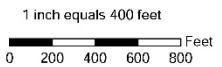

City of Moreno Valley Zoning Atlas



Current Zoning: NC
Proposed Zoning: COMU

Current Zoning: CC, OC, O, R30, R5 & P
Proposed Zoning: DC

The information shown on this map was compiled from the Riverside County GIS and the City of Moreno Valley GIS. The user bears the responsibility for obtaining the most current information and for verifying the accuracy of the information. Riverside County and City of Moreno Valley will not be responsible for any claims, losses or damages resulting from the use of this map.

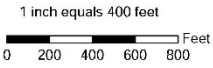

City of Moreno Valley Zoning Atlas

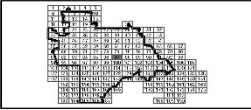

Current Zoning: CC, OC, O, R30, R5 & P
Proposed Zoning: DC

The information shown on this map was compiled from the Kern County GIS and the City of Moreno Valley GIS. The information is provided for informational purposes only and does not constitute an offer of independent financial or other services. Sources: City of Moreno Valley. No liability will be accepted for any claims, losses or damages resulting from the use of this map.

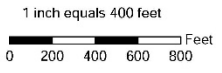
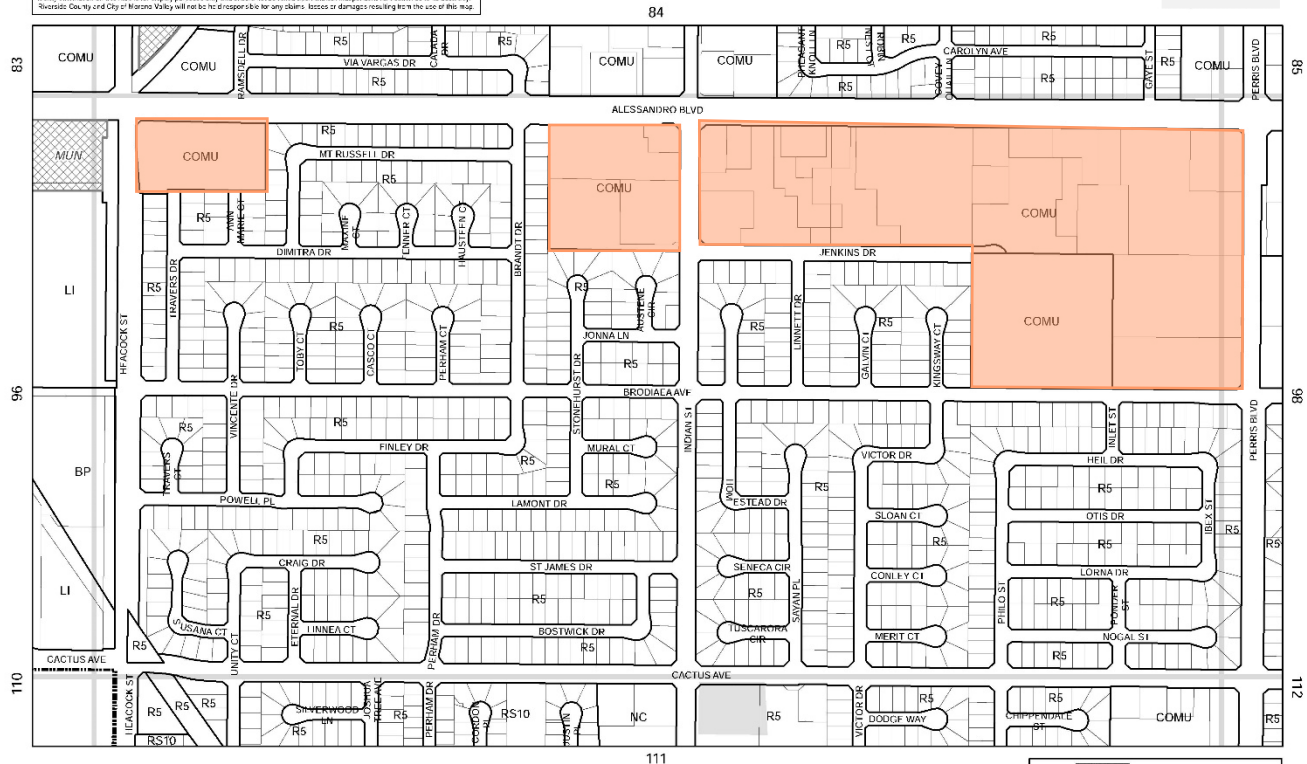

City of Moreno Valley Zoning Atlas

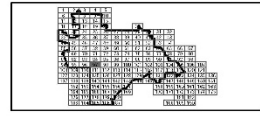

Current Zoning: NC, CC & R5
Proposed Zoning: COMU

The information shown on this map was compiled from the Riverside County GIS and the City of Moreno Valley GIS. The base and zoning information on this map is for display purposes only and should not be considered a final, no-warranty certificate as to its accuracy. Neither the City of Moreno Valley nor the staff responsible for this map assume any liability for errors or omissions resulting from this use of this map.

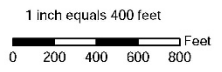
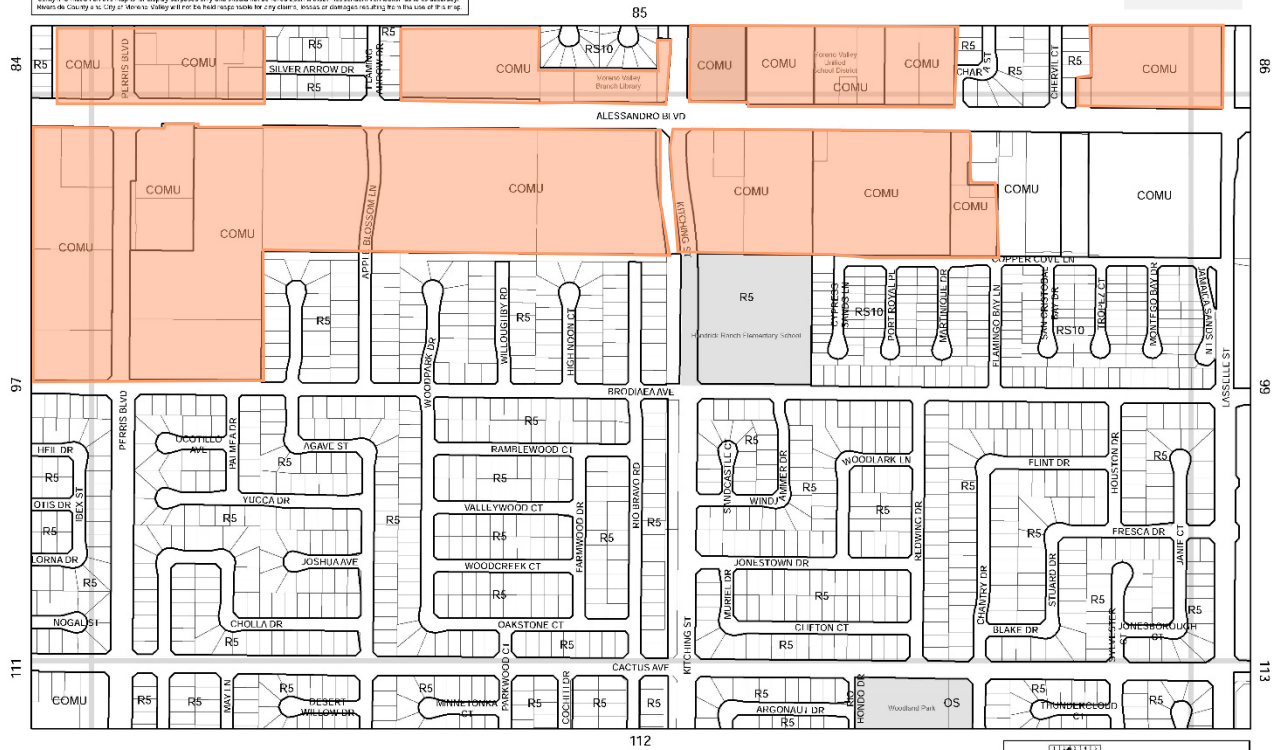

City of Moreno Valley Zoning Atlas

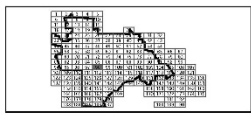

Current Zoning: NC, CC, OC, O, R10 & R15
Proposed Zoning: COMU

The information shown on this map was compiled from the Riverside County GIS and the City of Moreno Valley GIS. If there is a discrepancy between the two maps, the Riverside County GIS shall prevail. The City of Moreno Valley will not be responsible for any claims, losses or damages resulting from the use of this map.

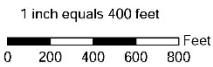

City of Moreno Valley Zoning Atlas

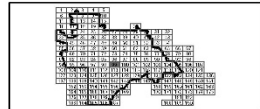

Current Zoning: NC, CC, OC, O, R30 & OS
Proposed Zoning: DC

The information shown on this map was compiled from the Riverside County GIS and the City of Moreno Valley GIS. The base and locally information was made for the display purposes only and should not be used as a final, non-conditional certificate as to its accuracy. Moreno Valley and Riverside County shall not be held liable for any errors, omissions or damages resulting from the use of this map.

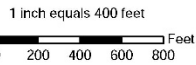
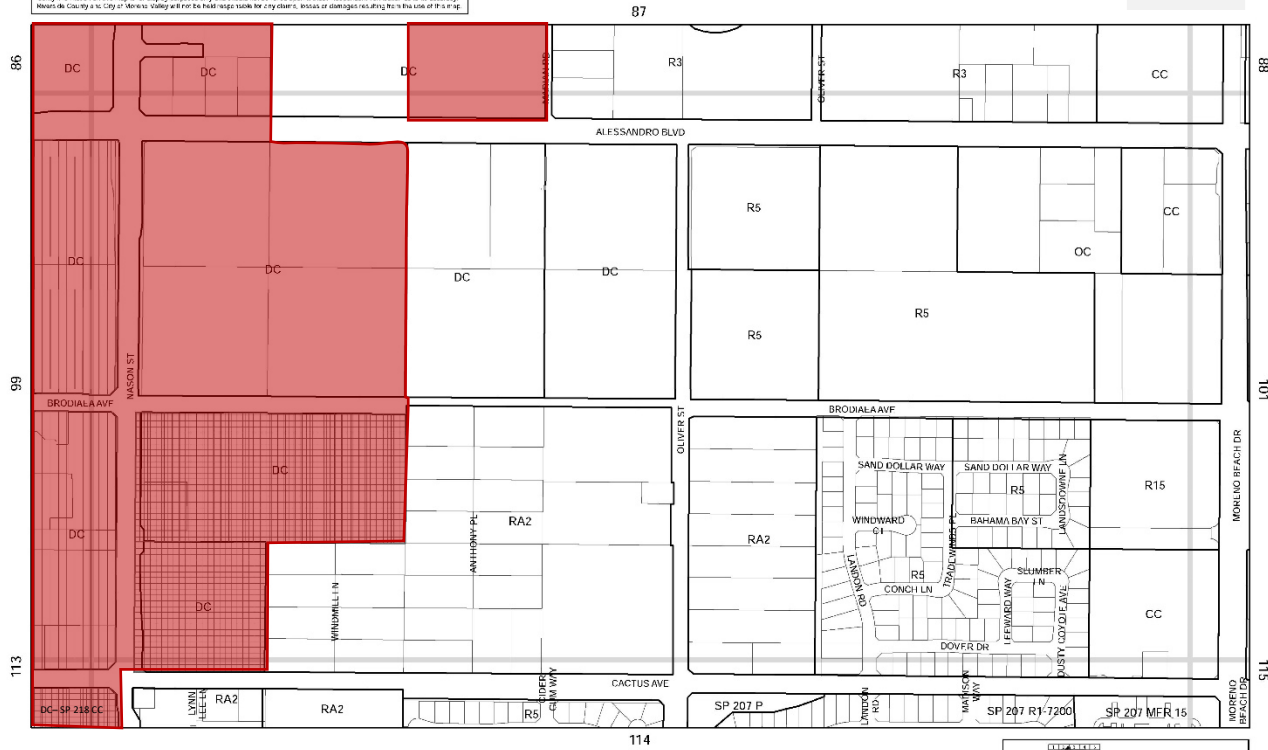

City of Moreno Valley Zoning Atlas

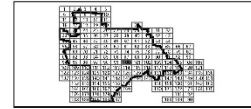

100

Current Zoning: NC, CC, R3, R5 & O
Proposed Zoning: DC

The information shown on this map was compiled from the Assessor's County GIS and the City of Moreno Valley GIS. The best available data was used to create this map. The City of Moreno Valley and the Assessor's Office are not responsible for any errors, omissions or damages resulting from the use of this map.

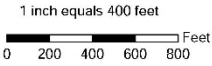
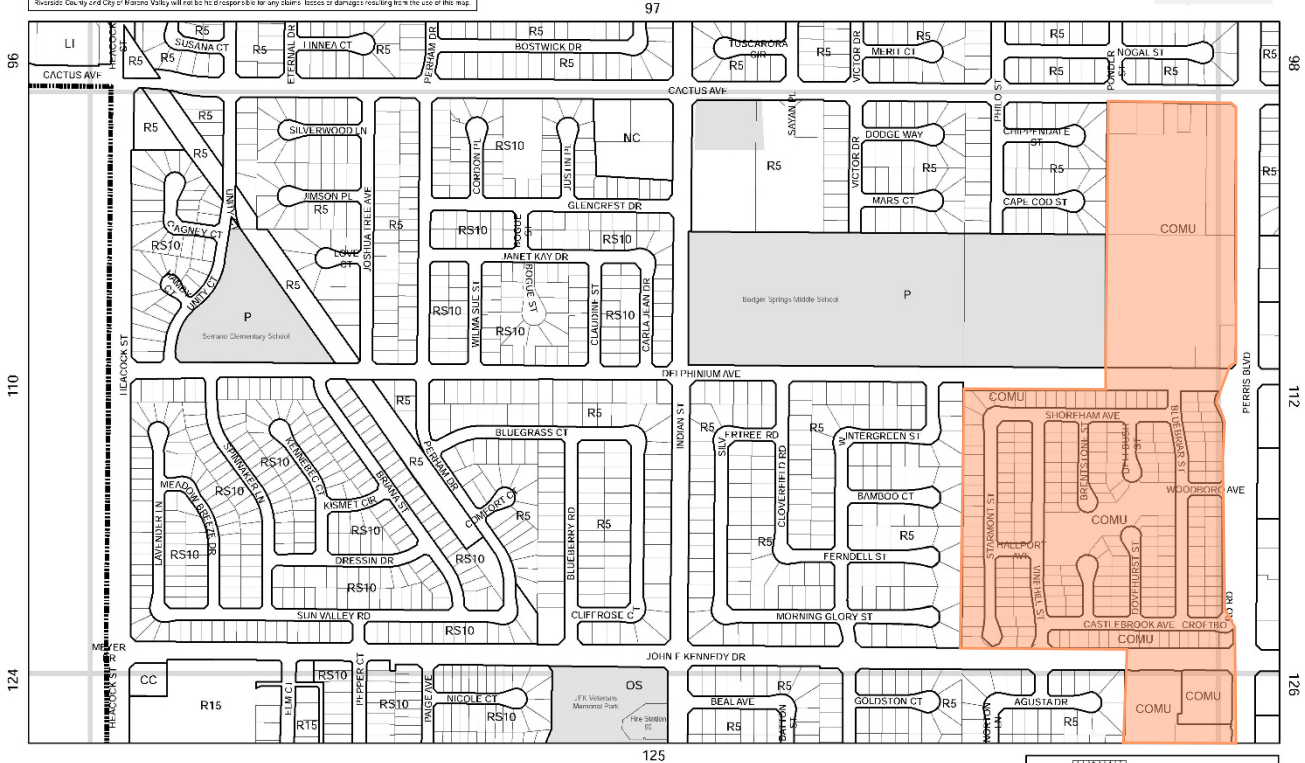

City of Moreno Valley Zoning Atlas



Current Zoning: NC, CC, R10 & RS10
Proposed Zoning: COMU

The information shown on this map was compiled from the Kern County GIS and the City of Moreno Valley GIS. The data used and liability information on this map is for city purposes only and should not be relied upon as being a total or complete representation of the City of Moreno Valley. The City of Moreno Valley is not responsible for any errors, omissions or damages resulting from the use of this map.

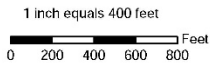
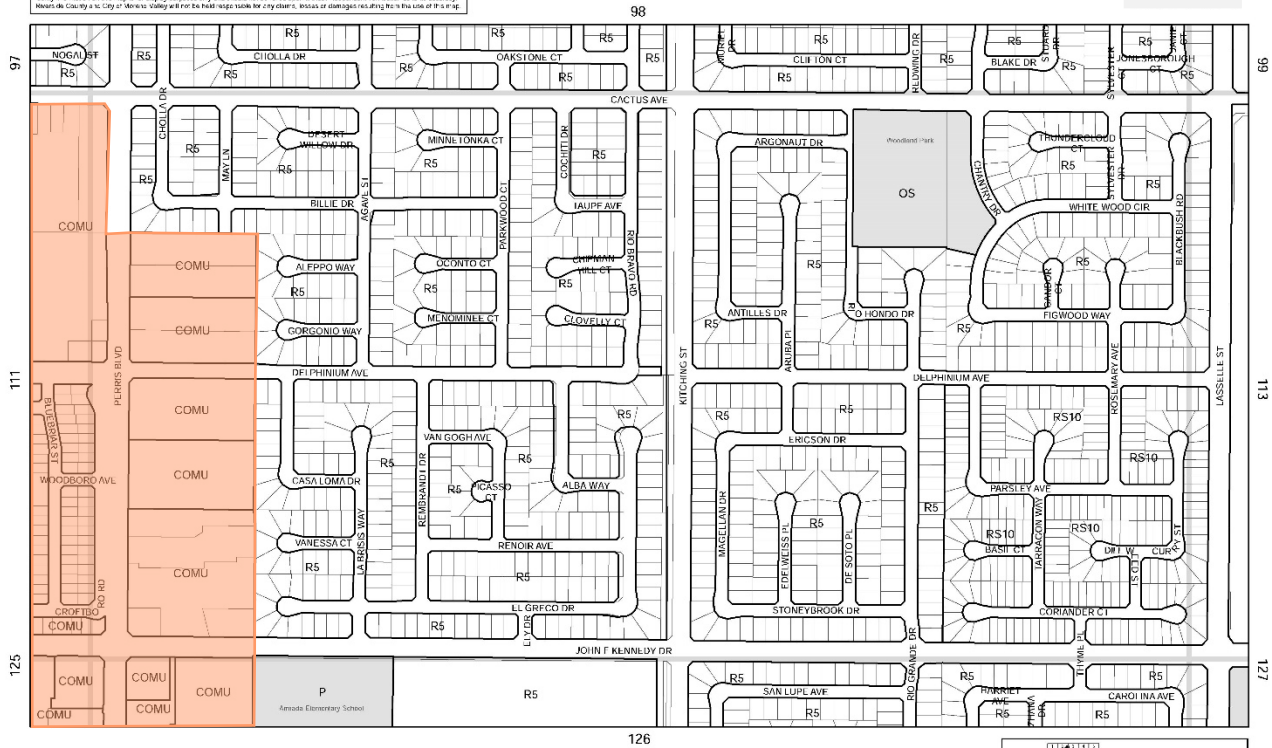

City of Moreno Valley Zoning Atlas

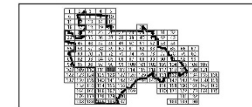

112

Current Zoning: NC, O, R20, R10 & RS10
Proposed Zoning: COMU

The information shown on this map was compiled from the Riverside County GIS and the City of Moreno Valley GIS. The data base and liability for the information on this map is the responsibility of the user and should not be used as a basis for any legal action. No warranty, express or implied, is made by the City of Moreno Valley or the Riverside County GIS. No liability shall be assumed for any errors or omissions, or for any damages, resulting from the use of this map.

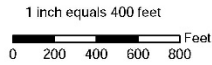
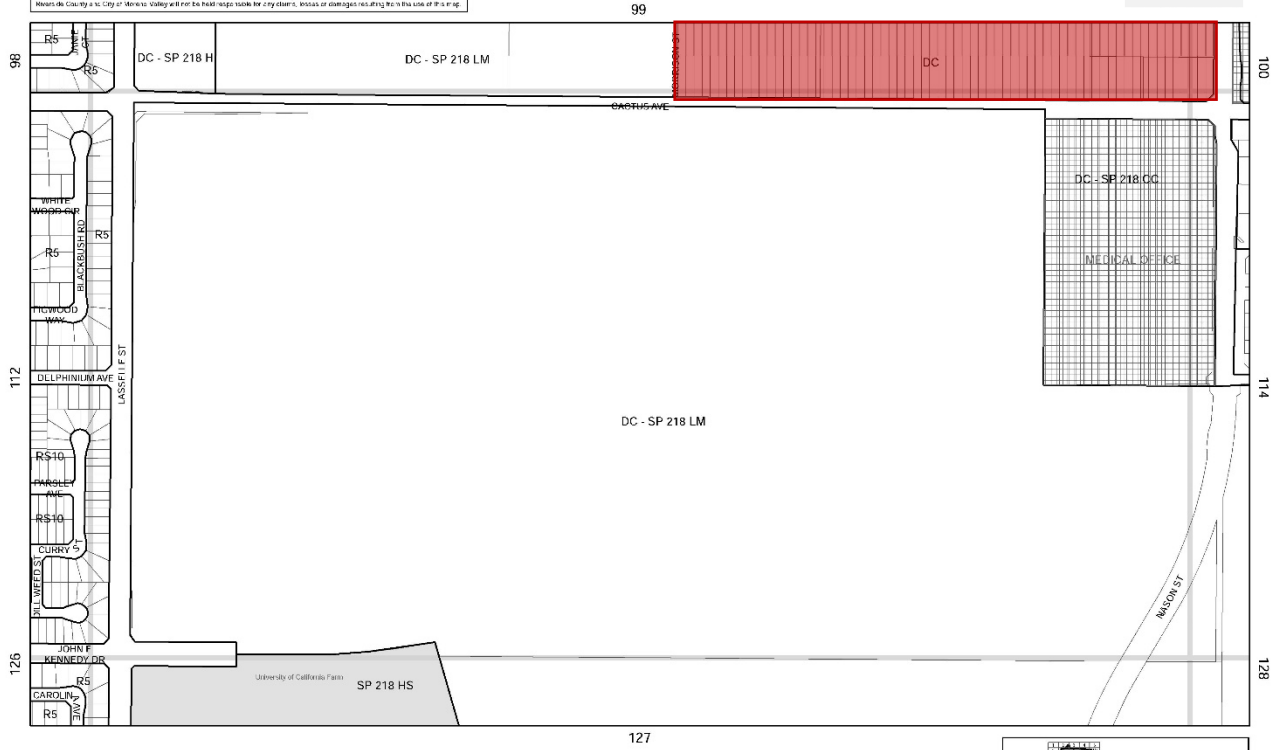

City of Moreno Valley Zoning Atlas

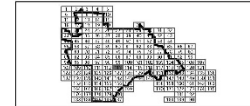

113

Current Zoning: CC
Proposed Zoning: DC

The information shown on this map was compiled from the Riverside County GIS data for the City of Moreno Valley. The City of Moreno Valley is not responsible for the accuracy of the information shown on this map. The City of Moreno Valley is not responsible for any claims, losses or damages resulting from the use of this map.

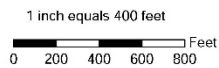
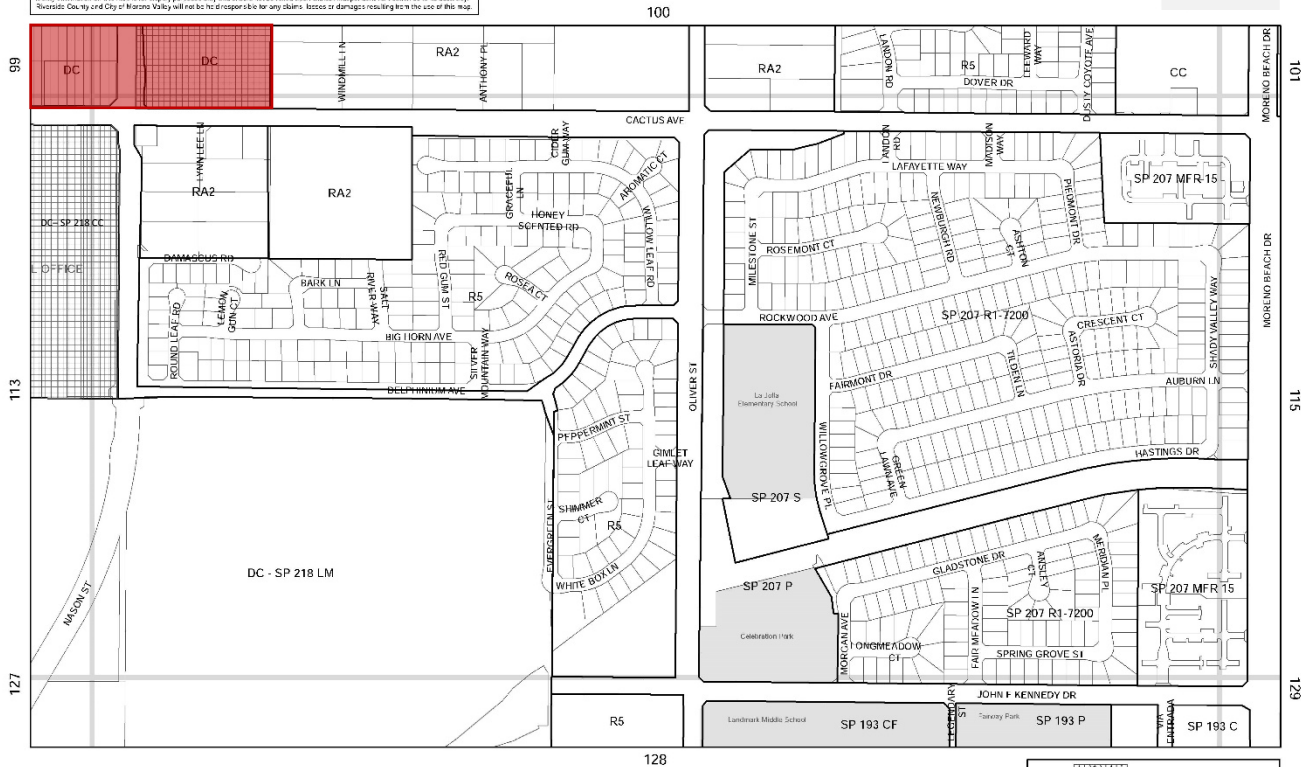

City of Moreno Valley Zoning Atlas



Current Zoning: CC & RA2
Proposed Zoning: DC



The information shown on this map was compiled by the Riverside County GIS and the City of Moreno Valley GIS. The board does not warrant the accuracy of the map for design purposes and shall not be held liable for any claims, losses or damages resulting from the use of this map.

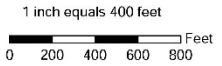
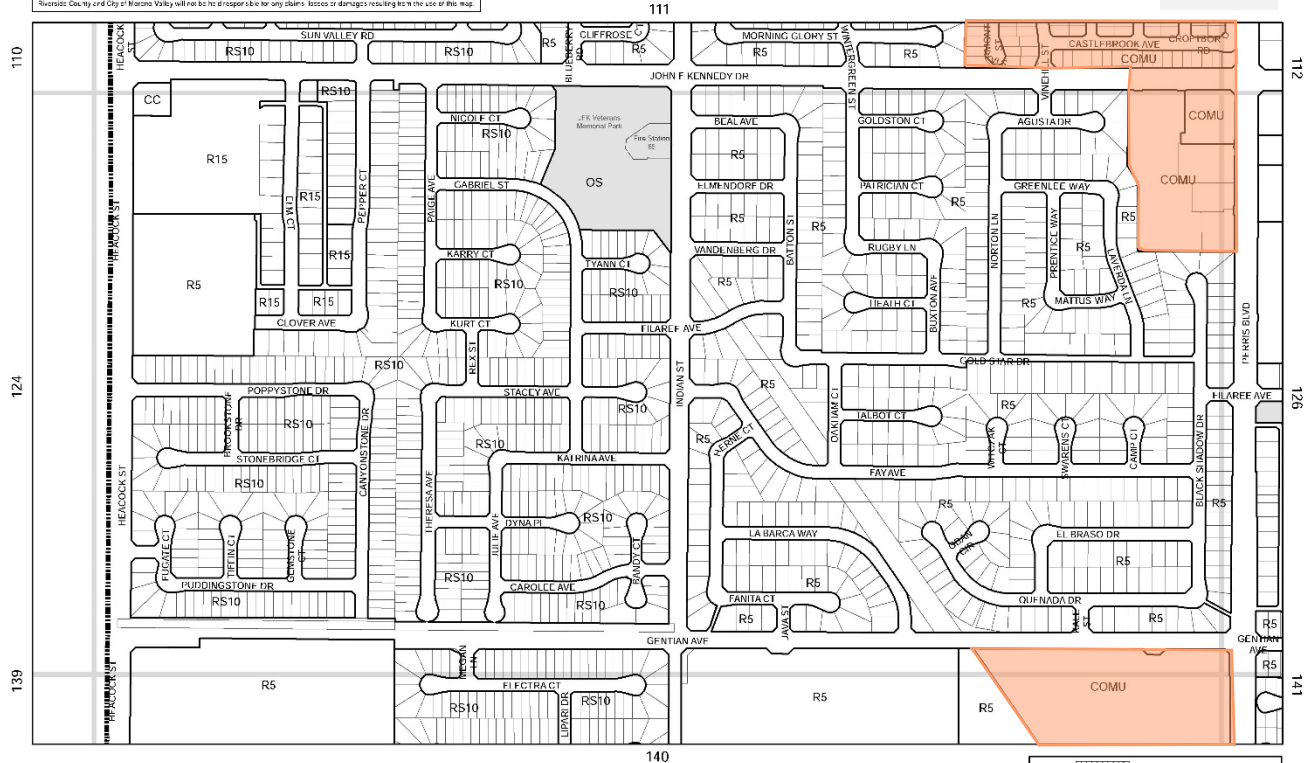

City of Moreno Valley Zoning Atlas

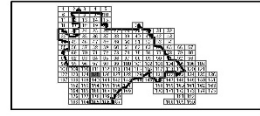

125

Current Zoning: NC, CC & RS10
Proposed Zoning: COMU

The information shown on this map was compiled from the Inland Empire County GIS and the City of Moreno Valley GIS. The information is for informational purposes only and should not be relied upon for legal purposes. The City of Moreno Valley, Riverside County and City of Moreno Valley will not be responsible for any claims, losses or damages resulting from the use of this map.

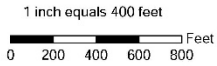
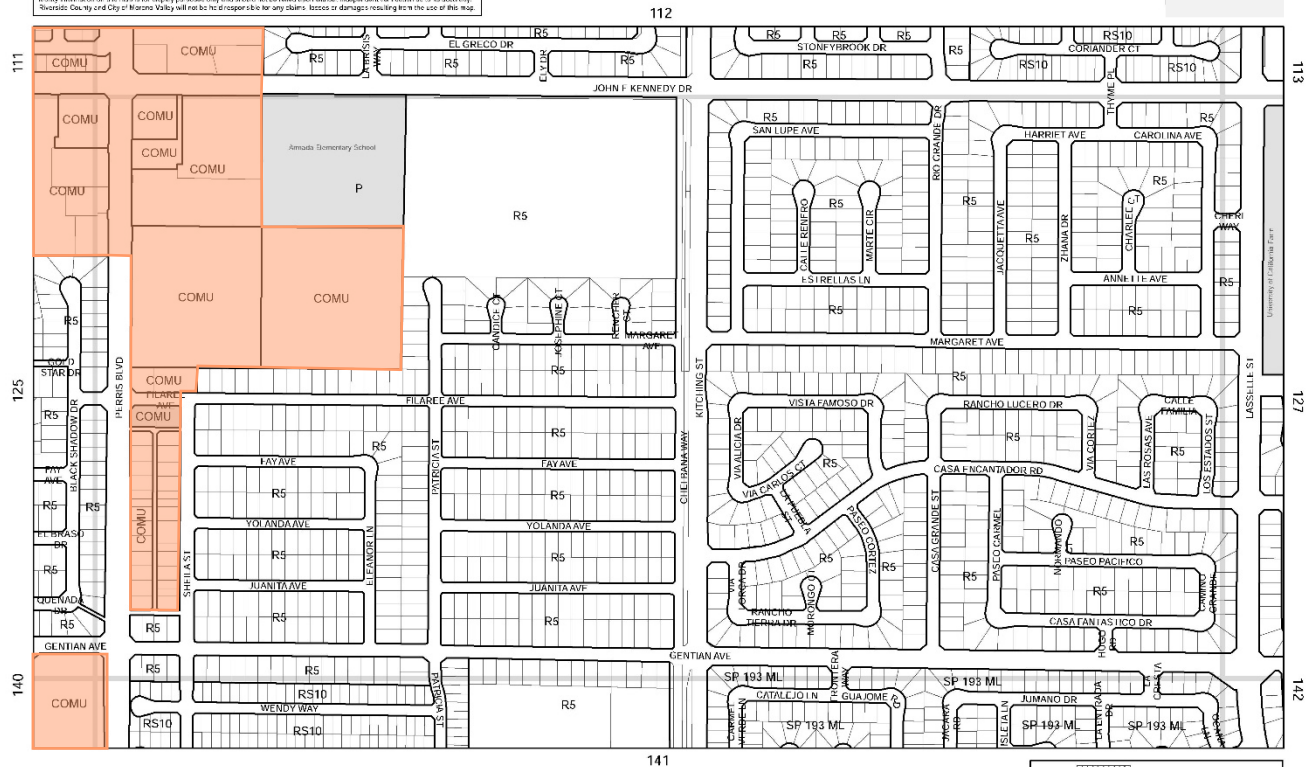

City of Moreno Valley Zoning Atlas



Current Zoning: NC, CC, R15 & R20
Proposed Zoning: COMU

The information shown on this map was compiled from the Riverside County GIS and the City of Moreno Valley GIS. The base and utility information on this map is for display purposes only and should not be used as a basis for boundary or coloration as to its accuracy. Riverside County and City of Moreno Valley will not be held liable for any errors, omissions or damages resulting from the use of this map.

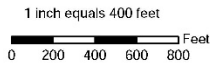
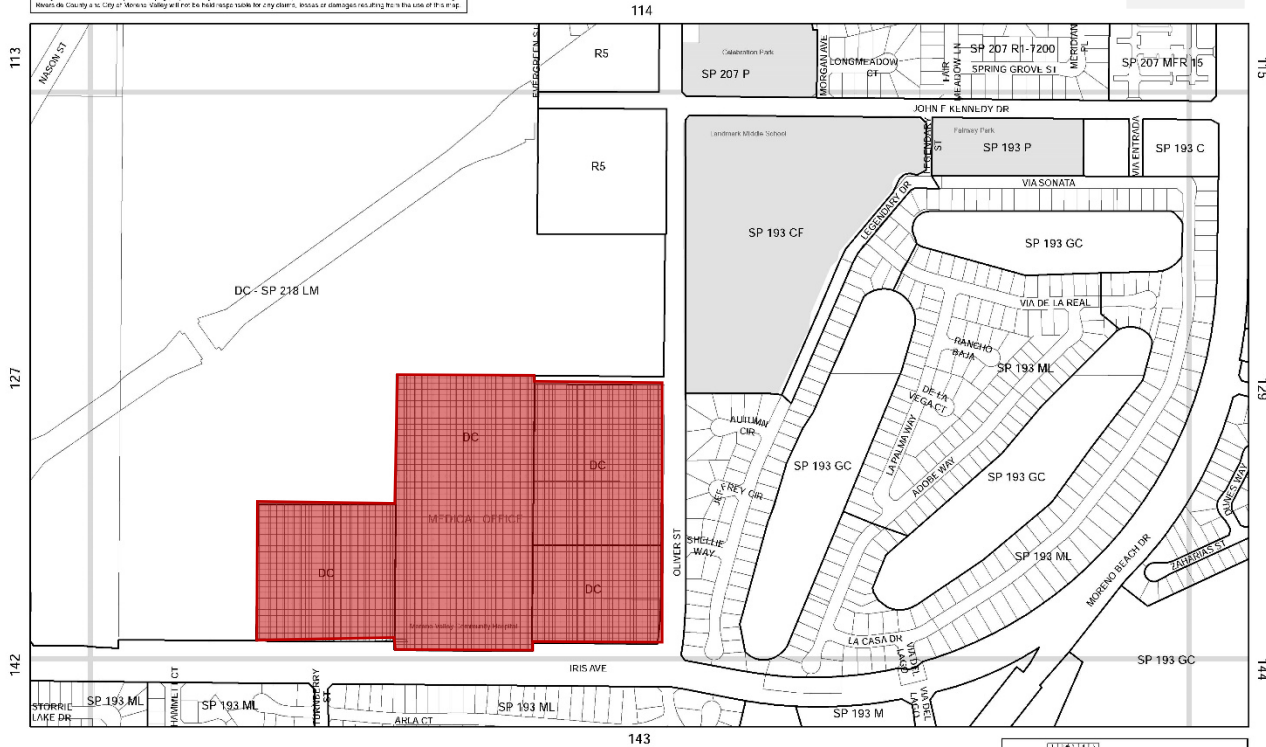

City of Moreno Valley Zoning Atlas

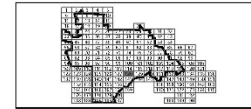

Current Zoning: CC, NC, OC & O
Proposed Zoning: DC

The information shown on this map was compiled by the Alameda County GIS and the City of Moreno Valley GIS. The information is for informational purposes only and should not be relied upon without independent verification. Riverside County and City of Moreno Valley will not be responsible for any claims, losses or damages resulting from the use of this map.

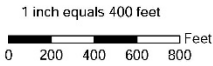
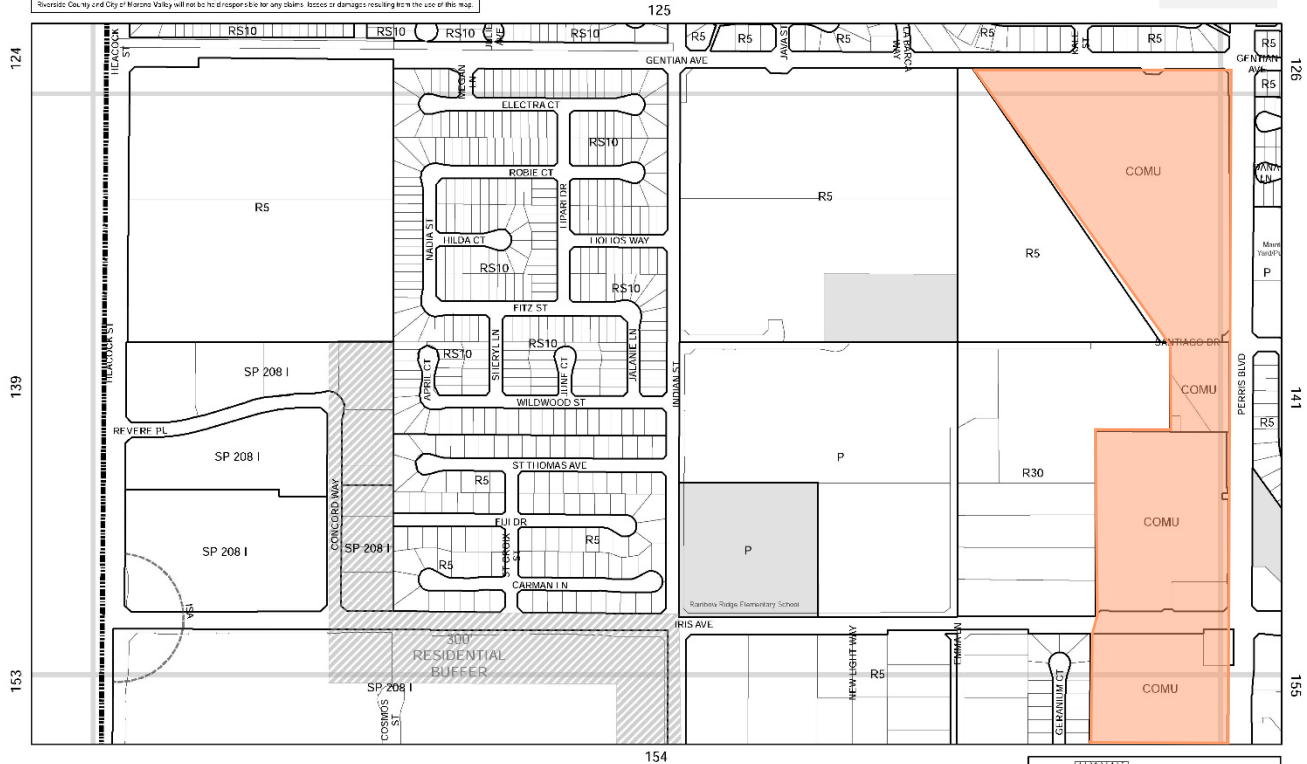

City of Moreno Valley Zoning Atlas

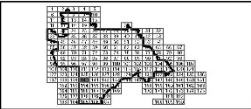

140

Current Zoning: NC & CC
Proposed Zoning: COMU

The information shown on this map was compiled from the Kern County GIS and the City of Moreno Valley GIS. The lot area and locality information on this map is for display purposes only and should not be used as a basis for any legal action. The borders of the color are for its accuracy. Kern County is the City of Moreno Valley and the Kern County GIS is the City of Moreno Valley. Areas of damage are along the boundary of the map.

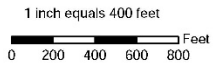

City of Moreno Valley Zoning Atlas

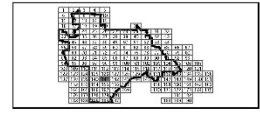

Current Zoning: NC & CC
Proposed Zoning: COMU

The information shown on this map was compiled from the Riverside County GIS and the City of Moreno Valley GIS. The line, area and color information on this map is for display purposes only and should not be used as a final record or boundary indicator, as its accuracy, completeness or the City of Moreno Valley will not be held responsible for any errors, omissions or omissions resulting from the use of this map.

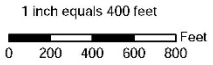

City of Moreno Valley Zoning Atlas

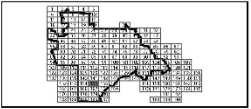

155

Current Zoning: NC & CC
Proposed Zoning: COMU